

## HR01直线导轨 Linear guide rails



### 产品特性 Product features

- 很小的导轨安装宽度15-23mm
  - 安装宽度与孔距与标准滚珠导轨保持一致
  - 表面经过硬质氧化铝合金
  - 可拼接实现超长导轨设计
  - 配合HRC免维护滑台使用
  - 轻量化设计
- Small installation width from 15 to 23 mm
  - The installation width and the holes are consistent with the standard ball guide rails
  - Made of hard anodized surface of aluminum alloy
  - Available longer design by the guide rails connection
  - Maintenance-free with HRC roller carragies
  - Lightweight design

## 标准规格 Standard specifications

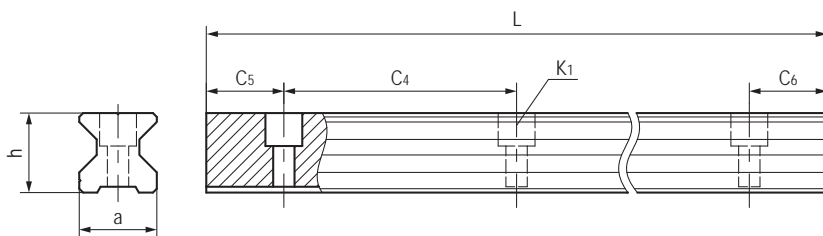

产品编码 Part No.:

HR01-15-0000

长度 Length  
宽度 Width

产品编码 Part No.	a [mm]	h [mm]	C <sub>5</sub> =C <sub>6</sub> [mm]		C <sub>4</sub> [mm]	K <sub>1</sub> [mm]	L max. [mm]	重量 Weight [g/m]
			min.	max.				
HR01-15-0000	15	18.7	10	50	60	M4	2500	600
HR01-20-0000	20	20.5	10	50	60	M5	2500	830
HR01-25-0000	23	24	10	50	60	M6	2500	1150

### HRC01滚轮滑台 Roller carriages



### 产品特性 Product features

- 滚轮滑台带除尘与防撞缓冲片设计
- 非常适合高速应用，最高速度10m/s
- 顺畅运动，驱动力约为滑动滑台的10%
- 安装螺纹孔与标准滚珠滑块保持一致
- 带间隙补偿调节功能
- 多版本可选：ST-标准高耐磨，HT-高耐温，VQ-低噪音
- 最高长期使用温度：ST-90℃，HT-120℃，VQ-70℃
- 自润滑、免维护，抗灰尘、无噪音
- With dust removal and anti-collision buffer elastic plate design
- Very suitable for high speed applications, the speed up to 10m/s
- Smooth moving, Driving force is about 10% of sliding carriages
- Installation threaded holes are consistent with the standard ball sliders
- Clearance adjustment, multi-version available: ST-standard anti-wear carriages, HT-high temperature carriages, VQ-very quiet carriages
- Max. long-term temperature: ST-90℃, HT-120℃, VQ-70℃
- Maintenance-free, dry-running, Resistant dust and no noise

### 标准规格 Standard specifications

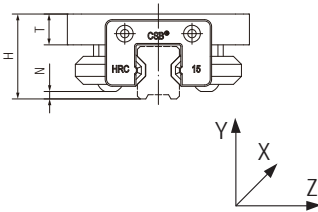
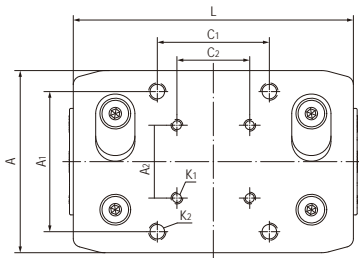

产品编码 Part No.:

HRC01-15-100-SR04-ST

ST-标准高耐磨滑台  
Standard anti-wear version  
HT-高耐温滑台 High temp version  
VQ-低噪音滑台 Very quiet version

滚轮数量 Roller quantities

滑台长度 Carriage length

导轨宽度 Guide rail width

产品编码 Part No.	A [mm]	A <sub>1</sub> [mm]	A <sub>2</sub> [mm]	C <sub>1</sub> [mm]	C <sub>2</sub> [mm]	L [mm]	H [mm]	N [mm]	T [mm]	K <sub>1</sub> [mm]	K <sub>2</sub> [mm]	静态载荷 Static load		重量 Weight [kg]
												Co <sub>y</sub> - [N]	Co <sub>z</sub> - [N]	
HRC01-15-100-BR04-ST	65	50	26	40	26	100	30.5	2.6	11	M4	M6	585	2340	0.25
HRC01-20-110-BR04-ST	75	60	32	45	36	110	32	2.0	11	M5	M8	820	3280	0.29
HRC01-25-120-BR04-ST	85	65	35	50	35	120	36	3.5	12	M6	M8	925	3700	0.40
HRC01-15-100-BR04-HT	65	50	26	40	26	100	30.5	2.6	11	M4	M6	585	2340	0.25
HRC01-20-110-BR04-HT	75	60	32	45	36	110	32	2.0	11	M5	M8	820	3280	0.29
HRC01-25-120-BR04-HT	85	65	35	50	35	120	36	3.5	12	M6	M8	925	3700	0.40
HRC01-15-100-BR04-VQ	65	50	26	40	26	100	30.5	2.6	11	M4	M6	585	2340	0.25
HRC01-20-110-BR04-VQ	75	60	32	45	36	110	32	2.0	11	M5	M8	820	3280	0.29
HRC01-25-120-BR04-VQ	85	65	35	50	35	120	36	3.5	12	M6	M8	925	3700	0.40